

---

## DOOR HANDLES DESIGN

Discover our exclusive collection of uniquely designed, high quality door handles with finishes that complement and enhance the SALTO electronic locking platform.

**Welcome to SALTO Systems.**

[www.saltosystems.com](http://www.saltosystems.com)

**SALTO**  
inspired**access**



# DOOR HANDLE DESIGN

## Solutions suitable for any type of door style.

Security, efficiency and design are all essential aspects of access control in the current competitive market. SALTO offers complete solutions to each door type, both newly constructed and refurbished, by catering specifically to your needs.

It's time to replace or upgrade your building users and key management with SALTO wire-free access control technology. Our installed base of battery-operated electronic locks and solutions for the access control industry is one of the largest in the world.

**1**

### STANDARD HANDLES LINE

Minimalistic and simple handles, fitting any style while offering robustness and comfort.

**2**

### PREMIUM HANDLES LINE

Refined handles with a modern and stylish design.

**3**

### LUXURY HANDLES LINE

High quality handles designed by our partner, Colombo Design.



## ALL-INCLUSIVE ACCESS CONTROL SOLUTIONS TAILORED TO SUIT YOUR BUILDING'S NEEDS.

SALTO Systems revolutionized access control with the introduction of the SALTO Virtual Network SVN data-on-card technology and the battery-operated wire-free electronic lock range in 2001. For nearly 20 years SALTO has been synonymous with innovative solutions, including stand-alone, cloud-based and mobile applications, that set new standards in security, manageability, flexibility and design that bring real-world benefits to virtually any type of door.

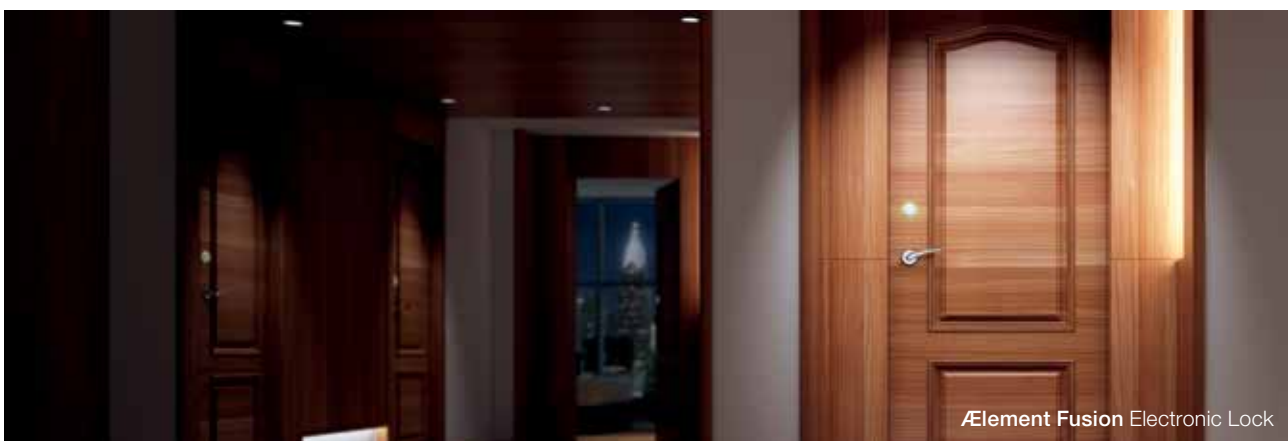



## STANDARD

The standard line provides minimalistic and simple handles, fitting any style while offering robustness and comfort. Their linear shapes make them multifunctional and easy to implement in any environment. Manufactured by SALTO, they fulfill their function in the most efficient way possible. The choice of finishes allow you to choose between 6 types of appearances.

**L HANDLE** | LONDON HANDLE - STANDARD LINE



**TECHNICAL CHARACTERISTICS:**

- Stainless steel tube base with positioning studs.
- Dimensions: 130mm x 62mm.
- Spindles available: 8mm and 9mm.
- Concealed through-screw technology.
- Reversible handle left or right.

**FINISH:**

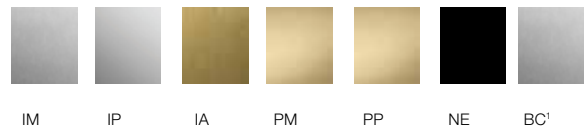

**COMPATIBLE WITH:**

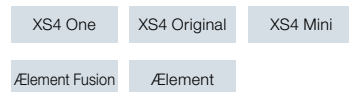

**HANDLE TECHNICAL DRAWING:**

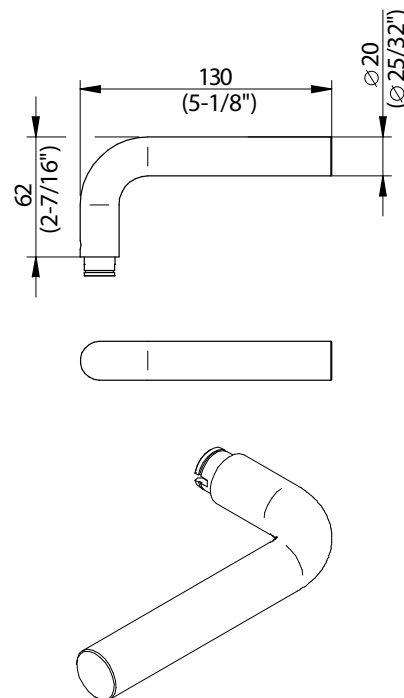

**ROSE MODELS:**

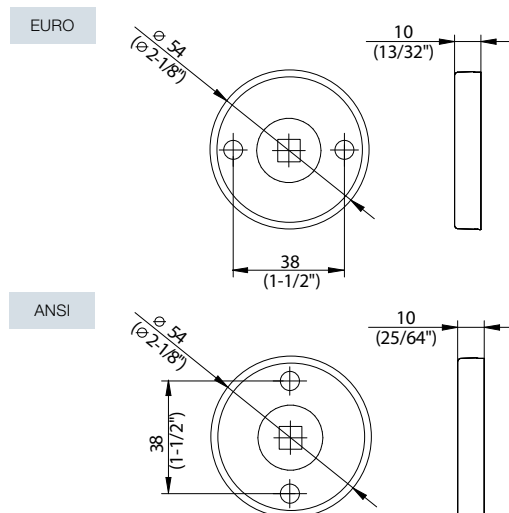

¹ BioCote silver ion antimicrobial technology  
Not available for Element

U HANDLE | UTRECHT HANDLE - STANDARD LINE



**TECHNICAL CHARACTERISTICS:**

- Stainless steel tube base with positioning studs.
- Dimensions: 136mm x 62mm.
- Spindles available: 8mm and 9mm.
- Concealed through-screw technology.
- Reversible handle left or right.

**STANDARDS:**

- ADA
- EN179\*

\* Ei4 - Ei6 - Si4 - Si6 - Ei7 - Ei1  
in combination with the relevant mortise lock.

**FINISH:**

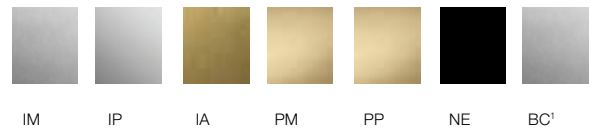

**COMPATIBLE WITH:**

- XS4 One
- XS4 Original
- XS4 Mini
- Ælement Fusion
- Ælement

**HANDLE TECHNICAL DRAWING:**

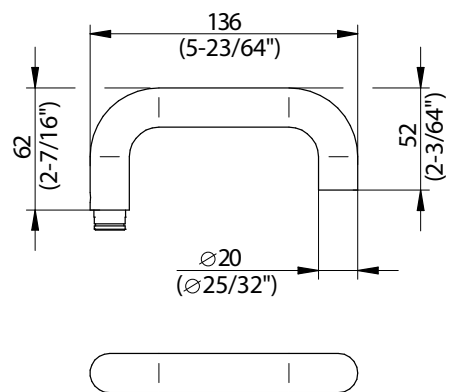

**ROSE MODELS:**

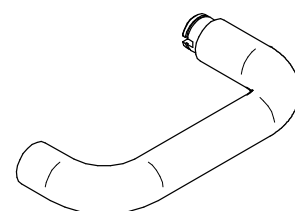
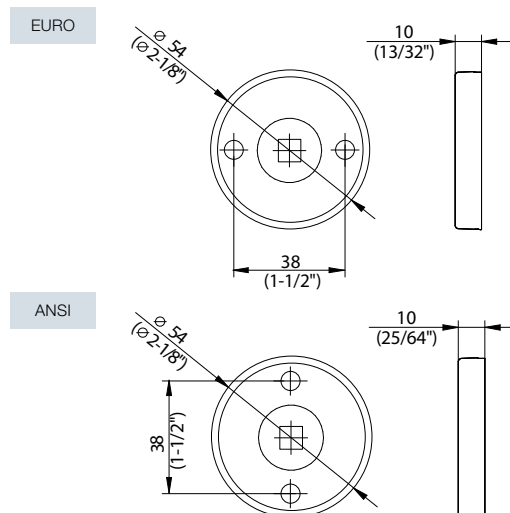

¹ BioCote silver ion antimicrobial technology  
Not available for Ælement

W HANDLE | WASHINGTON HANDLE - STANDARD LINE



**TECHNICAL CHARACTERISTICS:**

- Stainless steel tube base with positioning studs.
- Dimensions: 135mm x 62mm.
- Spindles available: 8mm and 9mm.
- Concealed through-screw technology.
- Reversible handle left or right.

**FINISH:**

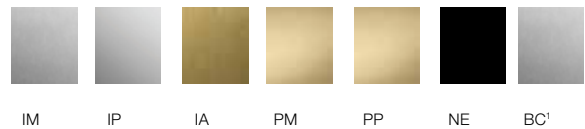

**COMPATIBLE WITH:**

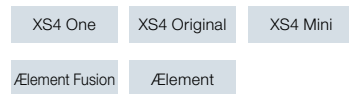

**HANDLE TECHNICAL DRAWING:**

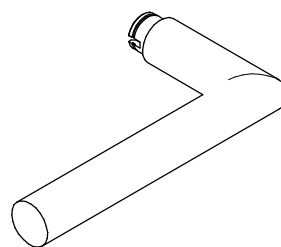
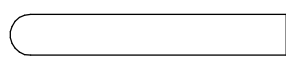
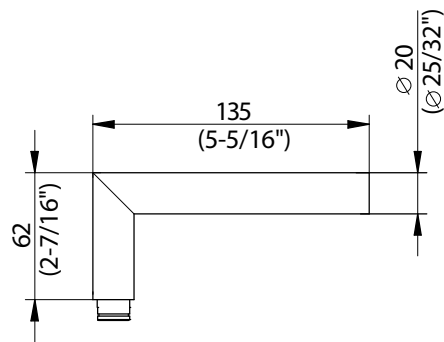

**ROSE MODELS:**

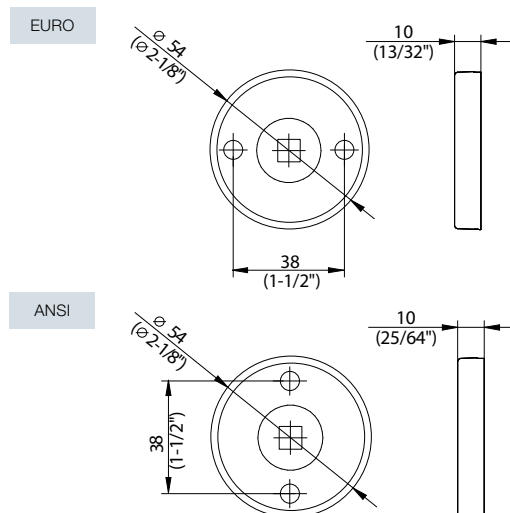

¹ BioCote silver ion antimicrobial technology  
Not available for Element

**N HANDLE** | NEW YORK HANDLE - STANDARD LINE



**TECHNICAL CHARACTERISTICS:**

- Solid stainless steel base with positioning studs.
- Dimensions: 127mm x 42,5mm.
- Spindles available: 8mm.
- Concealed through-screw technology.
- Reversible handle left or right.

**STANDARDS:**

ADA

**FINISH:**

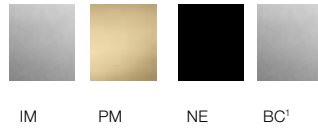

**COMPATIBLE WITH:**

- XS4 Original
- XS4 Mini
- Ælement Fusion
- Ælement

**HANDLE TECHNICAL DRAWING:**

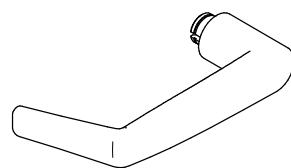
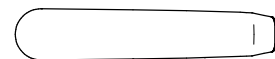
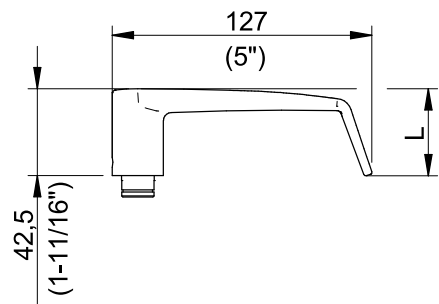

**ROSE MODELS:**

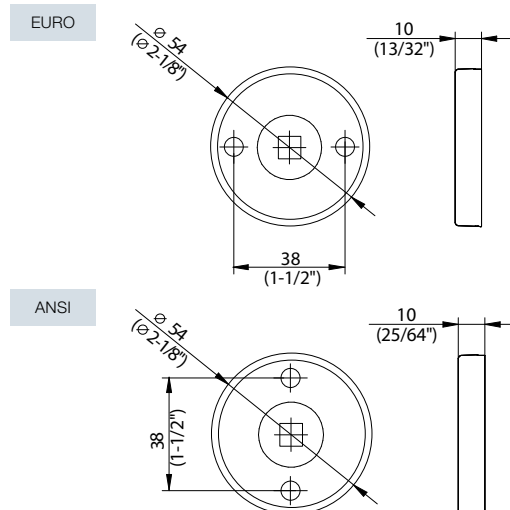

L	Compatibility
63 mm (2-31/64")	XS4 Original, XS4 One
42,5 mm (1-11/16")	XS4 Mini, Ælement, Ælement Fusion



**S HANDLE** | STOCKHOLM HANDLE - STANDARD LINE



**TECHNICAL CHARACTERISTICS:**

- Stainless steel tube base with positioning studs.
- Dimensions: 140mm x 62mm.
- Spindles available: 8mm.
- Concealed through-screw technology.
- Non-reversible handle. Right or Left.

**FINISH:**



IM    NE    BC<sup>1</sup>

**COMPATIBLE WITH:**

- XS4 One    XS4 Original    XS4 Mini
- ÆElement Fusion    ÆElement

**HANDLE TECHNICAL DRAWING:**

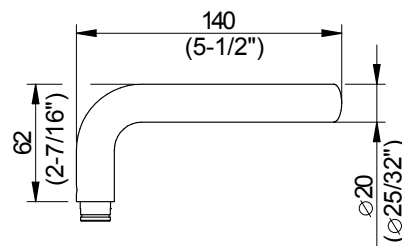

**ROSE MODELS:**

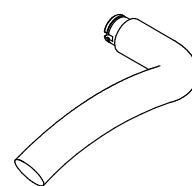
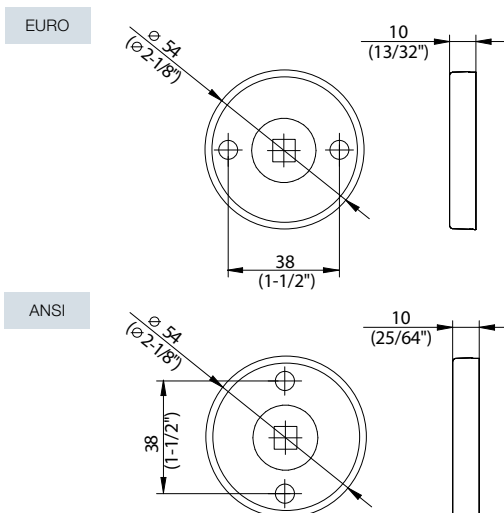

<sup>1</sup> BioCote silver ion antimicrobial technology  
Not available for ÆElement

Z HANDLE | ZODIAC HANDLE - STANDARD LINE



**TECHNICAL CHARACTERISTICS:**

- Stainless steel tube base with positioning studs.
- Dimensions: 158mm x 52,5mm.
- Spindles available: 8mm.
- Concealed through-screw technology.
- Reversible handle left or right.

**STANDARDS:**

ADA

**FINISH:**



IM NE BC

**COMPATIBLE WITH:**

XS4 One XS4 Original XS4 Mini  
 Element Fusion Element

**HANDLE TECHNICAL DRAWING:**

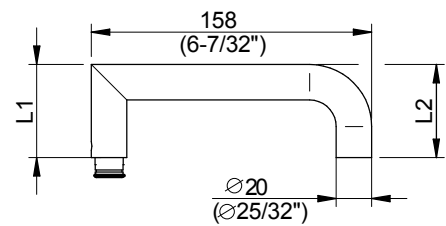

**ROSE MODELS:**

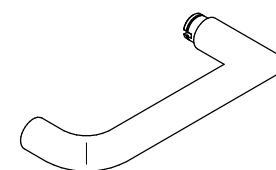
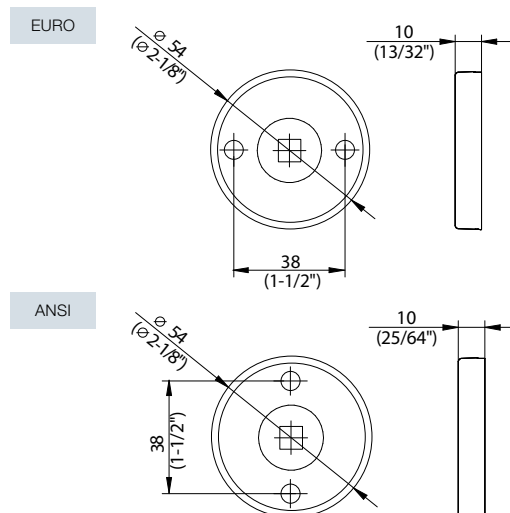

L1	L2	Compatibility
32,5 mm (1-9/32")	53,5 mm (2-7/64")	XS4 Original, XS4 One
52,5 mm (2-1/16")	52,5 MM (2-1/16")	XS4 Mini, Element, Element Fusion

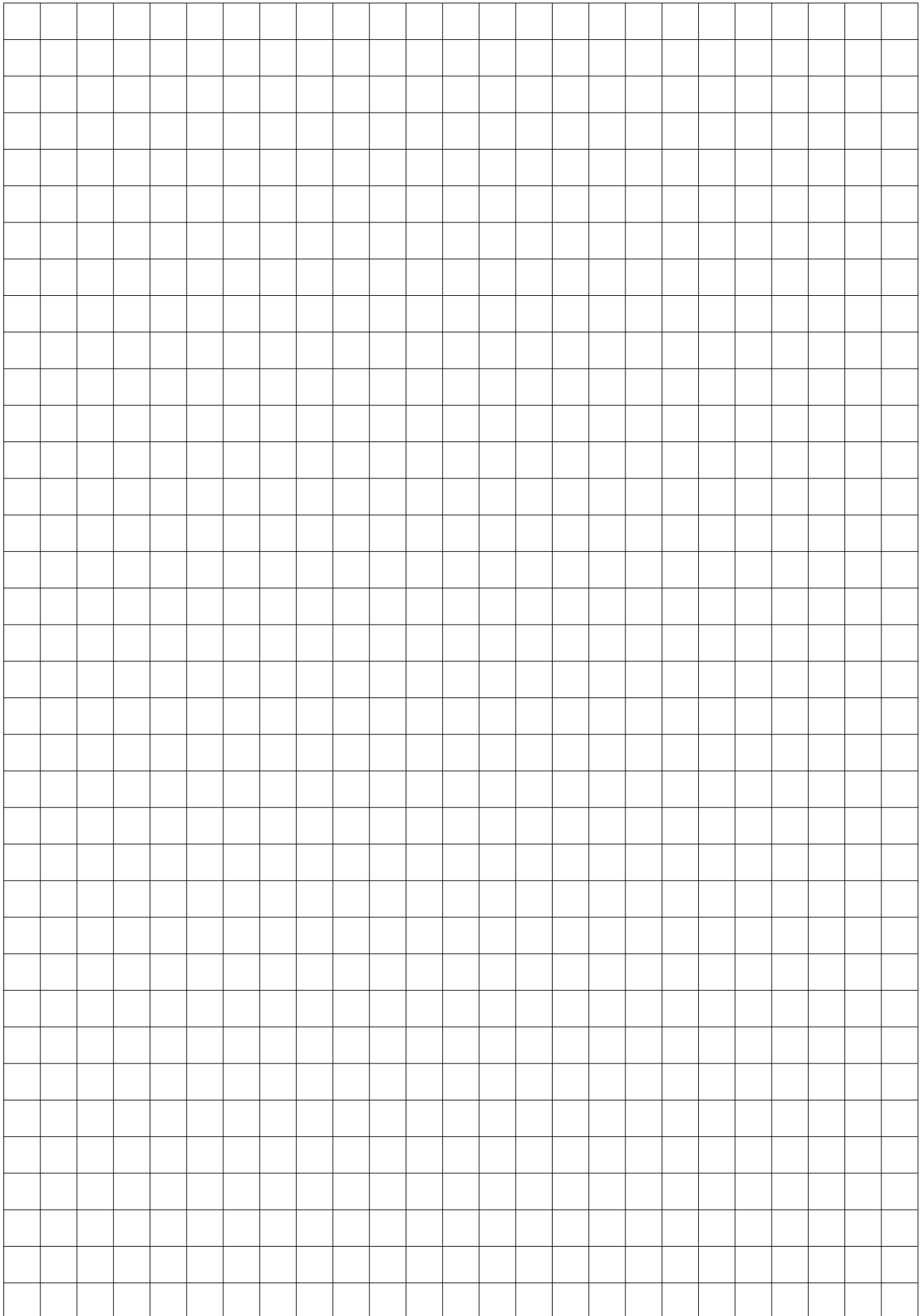

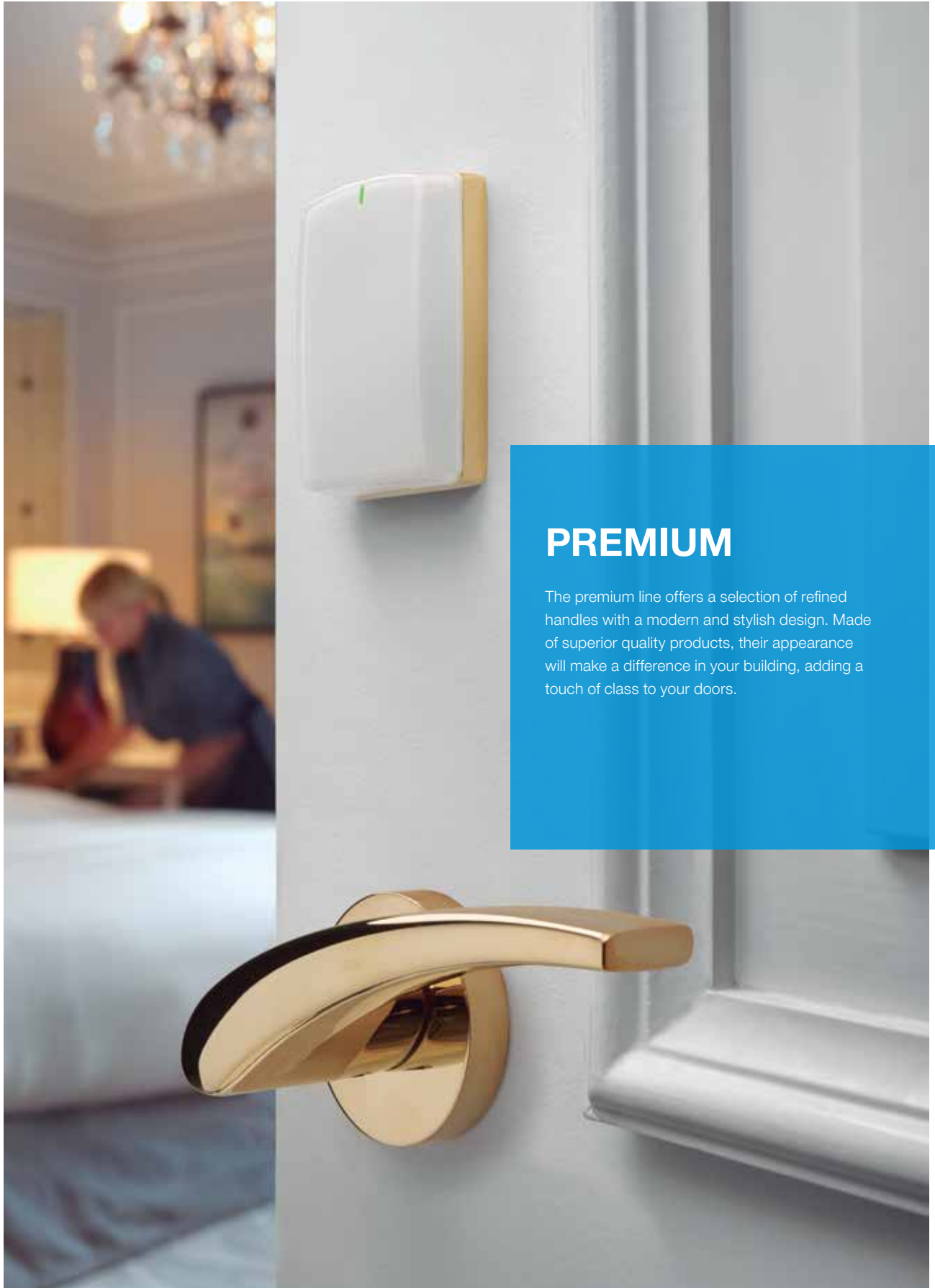

## PREMIUM

The premium line offers a selection of refined handles with a modern and stylish design. Made of superior quality products, their appearance will make a difference in your building, adding a touch of class to your doors.

**K HANDLE** | KINGSTON HANDLE - PREMIUM LINE



**TECHNICAL CHARACTERISTICS:**

- Zinc alloy base with positioning studs.
- Dimensions: 121mm x 50mm.
- Spindles available: 8mm and 9mm.
- Concealed through-screw technology.
- Non-reversible handle. Right or Left.

**FINISH:**

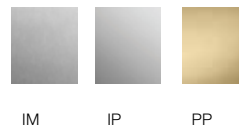

**COMPATIBLE WITH:**

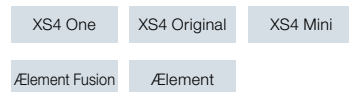

**HANDLE TECHNICAL DRAWING:**

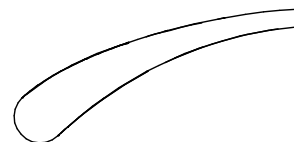
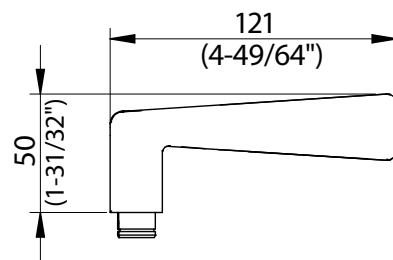

**ROSE MODELS:**

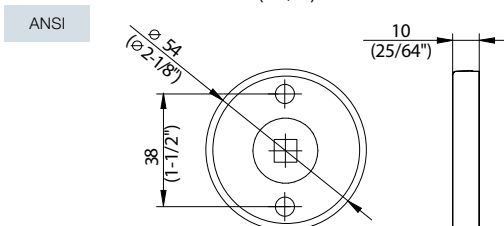
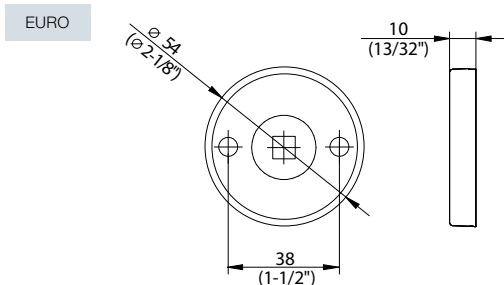

**J HANDLE** | JAKARTA HANDLE - PREMIUM LINE



**TECHNICAL CHARACTERISTICS:**

- Stainless steel tube base with positioning studs.
- Dimensions: 138mm x 62mm.
- Spindles available: 8mm.
- Concealed through-screw technology.
- Reversible handle left or right.

**FINISH:**

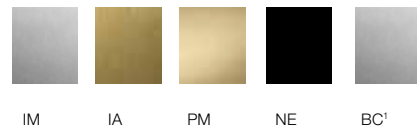

**COMPATIBLE WITH:**

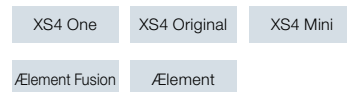

**HANDLE TECHNICAL DRAWING:**

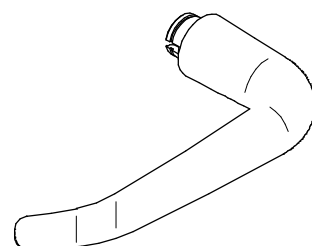
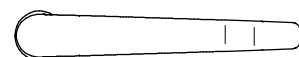
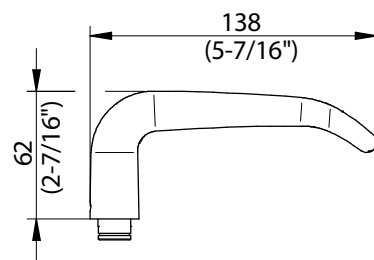

**ROSE MODELS:**

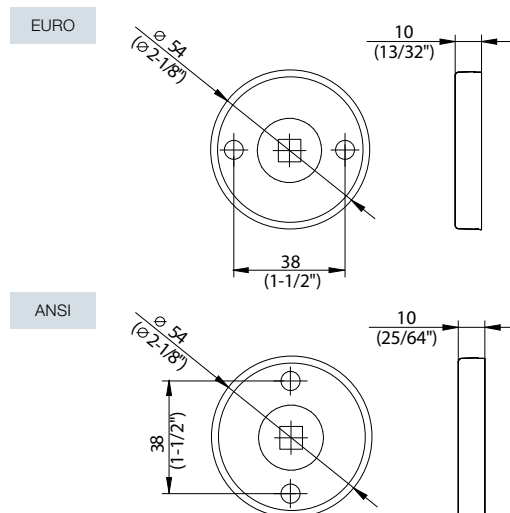

¹ BioCote silver ion antimicrobial technology  
Not available for Ælement

O HANDLE | OTTAWA HANDLE - PREMIUM LINE



**TECHNICAL CHARACTERISTICS:**

- Brass base with positioning studs.
- Dimensions: 120mm x 65mm.
- Spindles available: 8mm.
- Concealed through-screw technology.
- Non-reversible handle. Right or Left.

**FINISH:**

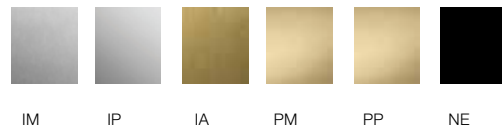

**COMPATIBLE WITH:**

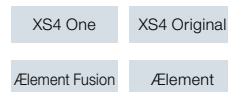

**HANDLE TECHNICAL DRAWING:**

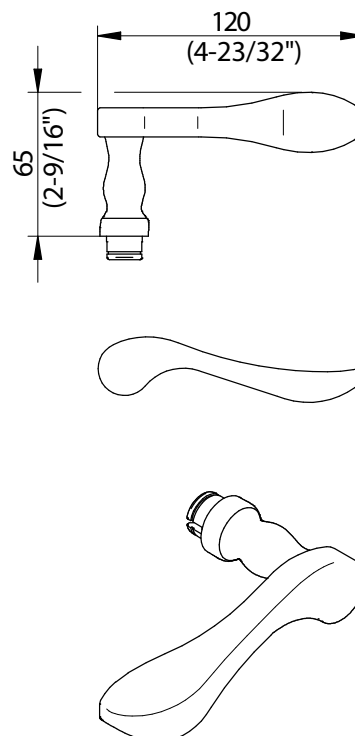

**ROSE MODELS:**

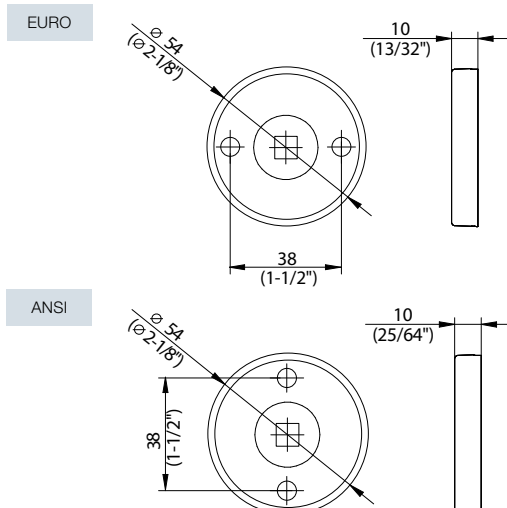

**G HANDLE** | [GEORGIA HANDLE - PREMIUM LINE](#)



**TECHNICAL CHARACTERISTICS:**

- Stainless steel base with positioning studs.
- Dimensions: 139mm x 42mm.
- Spindles available: 8mm.
- Concealed through-screw technology.
- Reversible handle left or right.

**STANDARDS:**

ADA

**FINISH:**

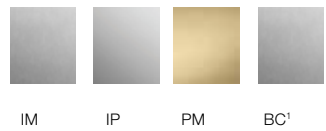

**COMPATIBLE WITH:**

- XS4 One
- XS4 Original
- XS4 Mini
- Ælement Fusion
- Ælement

**HANDLE TECHNICAL DRAWING:**

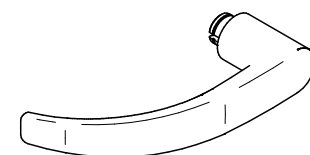
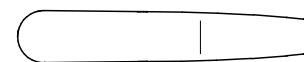
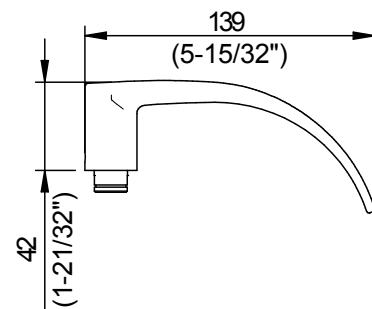

**ROSE MODELS:**

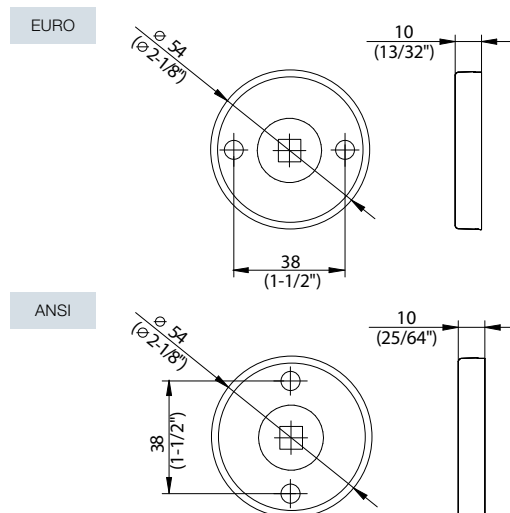

¹ BioCote silver ion antimicrobial technology  
Not available for Ælement



**T HANDLE** | TORONTO HANDLE - PREMIUM LINE



**TECHNICAL CHARACTERISTICS:**

- Brass steel base with positioning studs.
- Dimensions: 142mm x 62mm.
- Spindles available: 8mm.
- Concealed through-screw technology.
- Reversible handle left or right.

**STANDARDS:**

ADA

**FINISH:**

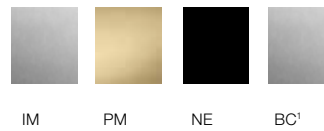

**COMPATIBLE WITH:**

- XS4 One
- XS4 Original
- XS4 Mini
- Ælement Fusion
- Ælement

**HANDLE TECHNICAL DRAWING:**

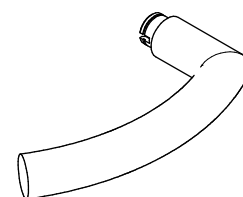
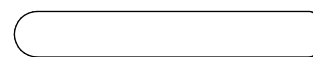
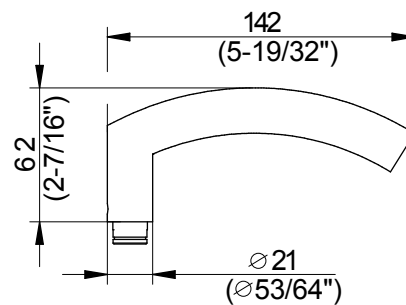

**ROSE MODELS:**

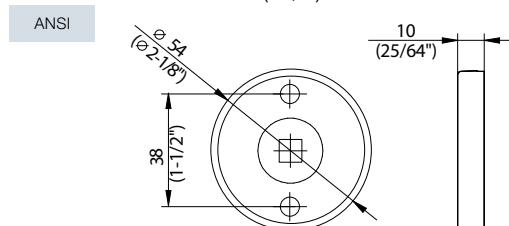
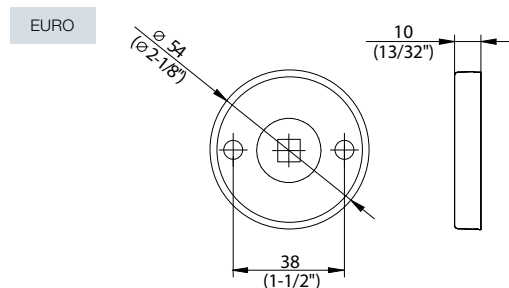

¹ BioCote silver ion antimicrobial technology  
Not available for Ælement



## LUXURY

The luxury line presents a range of high quality handles designed by our partner, Colombo Design. The Italian company picked its best pieces to offer the finest combination with SALTO's locking solutions. Their perfect finish and neat appearance will blend entirely with delicate surroundings, to embellish the most sophisticated places. The 6 types of finishes available will allow you to completely customize your locking solution.

2 HANDLE | ROBODUE HANDLE - LUXURY LINE



**TECHNICAL CHARACTERISTICS:**

- Zinc alloy base with positioning studs.
- Dimensions: 127mm x 56mm.
- Spindles available: 8mm.
- Concealed through-screw technology.
- Reversible handle left or right.

**FINISH:**



IM IP PP

**COMPATIBLE WITH:**

- XS4 One
- XS4 Original
- XS4 Mini
- Element Fusion
- Element

**HANDLE TECHNICAL DRAWING:**

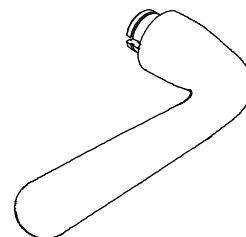
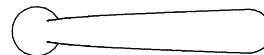
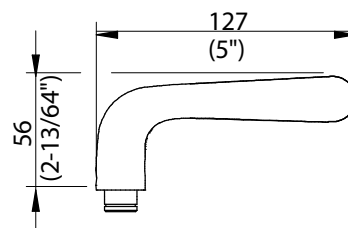

**ROSE MODELS:**

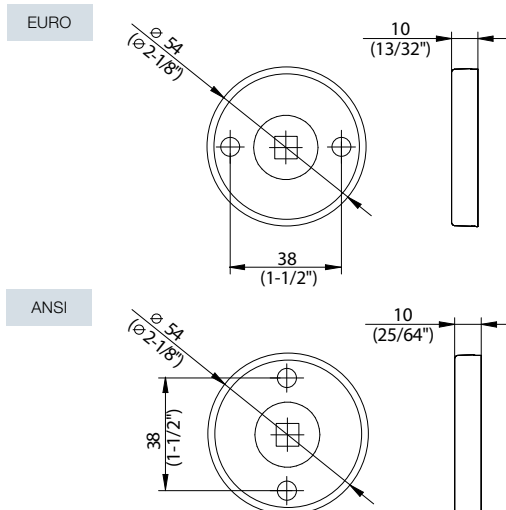

**3 HANDLE** | ROBOTRE HANDLE - LUXURY LINE



**TECHNICAL CHARACTERISTICS:**

- Zinc alloy base with positioning studs.
- Dimensions: 126mm x 52mm.
- Spindles available: 8mm.
- Concealed through-screw technology.
- Reversible handle left or right.

**FINISH:**

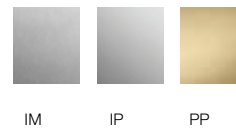

**COMPATIBLE WITH:**

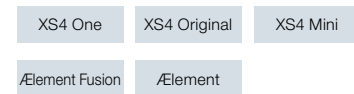

**HANDLE TECHNICAL DRAWING:**

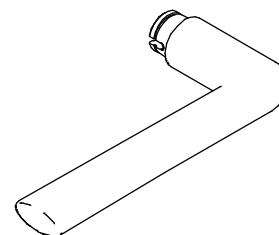
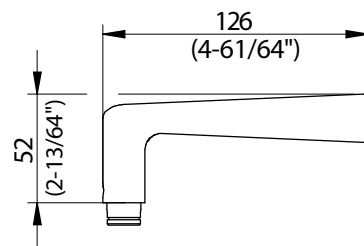

**ROSE MODELS:**

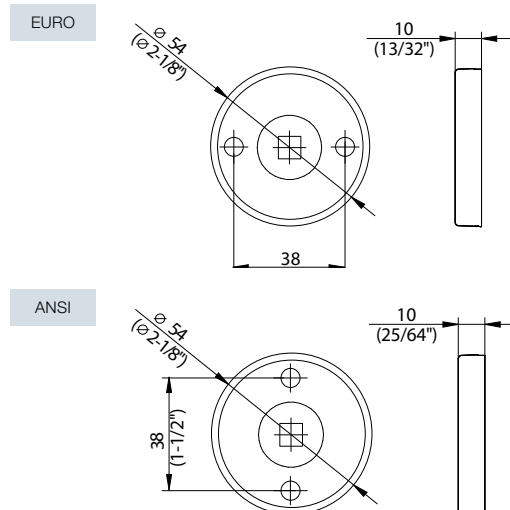

4 HANDLE | ROBOQUATTRO HANDLE - LUXURY LINE



**TECHNICAL CHARACTERISTICS:**

- Zinc alloy base with positioning studs.
- Dimensions: 128mm x 51mm.
- Spindles available: 8mm.
- Concealed through-screw technology.
- Reversible handle left or right.

**FINISH:**



IM IP PP

**COMPATIBLE WITH:**

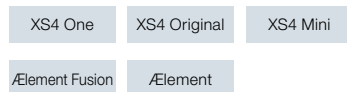

**HANDLE TECHNICAL DRAWING:**

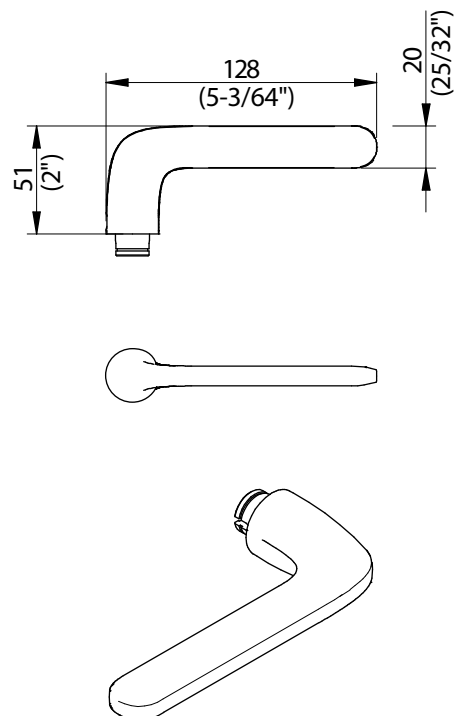

**ROSE MODELS:**

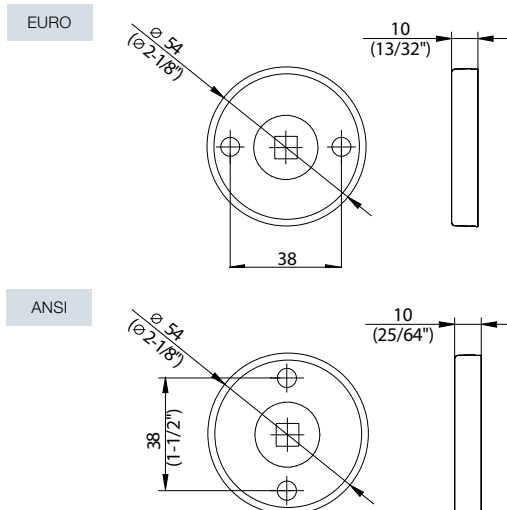

5 HANDLE | ELLE HANDLE - LUXURY LINE



**TECHNICAL CHARACTERISTICS:**

- Zinc alloy base with positioning studs.
- Dimensions: 120mm x 50mm.
- Spindles available: 8mm.
- Concealed through-screw technology.
- Reversible handle left or right.

**STANDARDS:**

ADA

**FINISH:**



IM IP PP

**COMPATIBLE WITH:**

- XS4 One
- XS4 Original
- XS4 Mini
- Element Fusion
- Element

**HANDLE TECHNICAL DRAWING:**

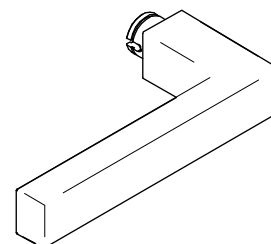
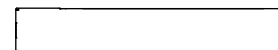
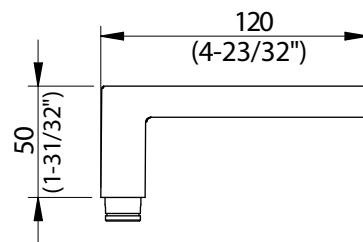

**ROSE MODELS:**

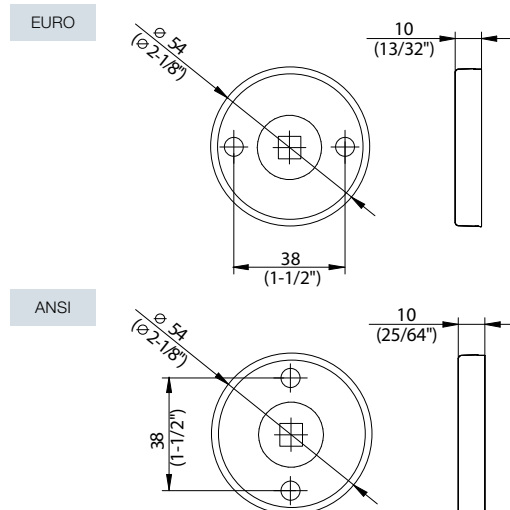

7 HANDLE | MACH HANDLE - LUXURY LINE



**TECHNICAL CHARACTERISTICS:**

- Zinc alloy base with positioning studs.
- Dimensions: 124mm x 52mm.
- Spindles available: 8mm.
- Concealed through-screw technology.
- Reversible handle left or right.

**STANDARDS:**

ADA

**FINISH:**



IM IP PP

**COMPATIBLE WITH:**

- XS4 One
- XS4 Original
- XS4 Mini
- Element Fusion
- Element

**HANDLE TECHNICAL DRAWING:**

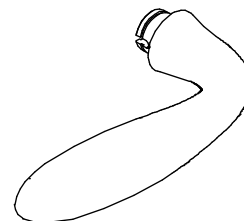
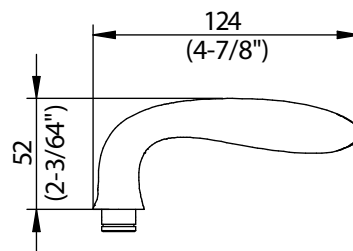

**ROSE MODELS:**

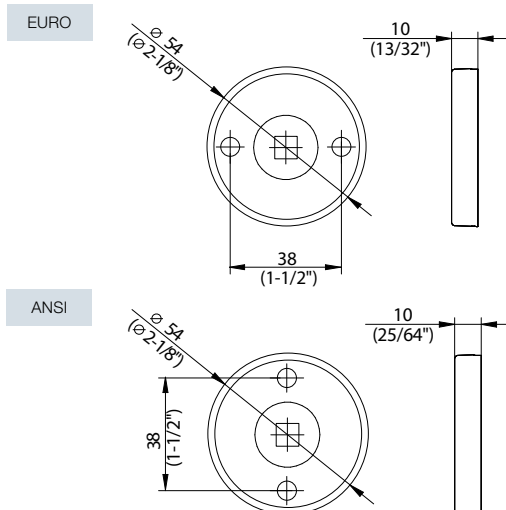

## BUILD YOUR OWN DOOR

### CUSTOMIZE YOUR ELECTRONIC DOOR LOCK

Select an electronic lock model, door type and customize your SALTO door lock with a range of colors, finishes & handle options.

This innovative tool will allow a complete visualization and customization of the locking solutions chosen by the user. By accessing the web page, the user is able to select the door lock model online to configure and create their customized door by personalizing everything. Select a model, door type, and customize your SALTO door lock with a wide range of colors, finishes & handles. This smart tool will help visitors have an idea of the look and feel of how the solutions look on different types of doors with different finishes, and by selecting different designs and lock models.

**SALTO continues to innovate by launching a unique tool for the access control industry.**

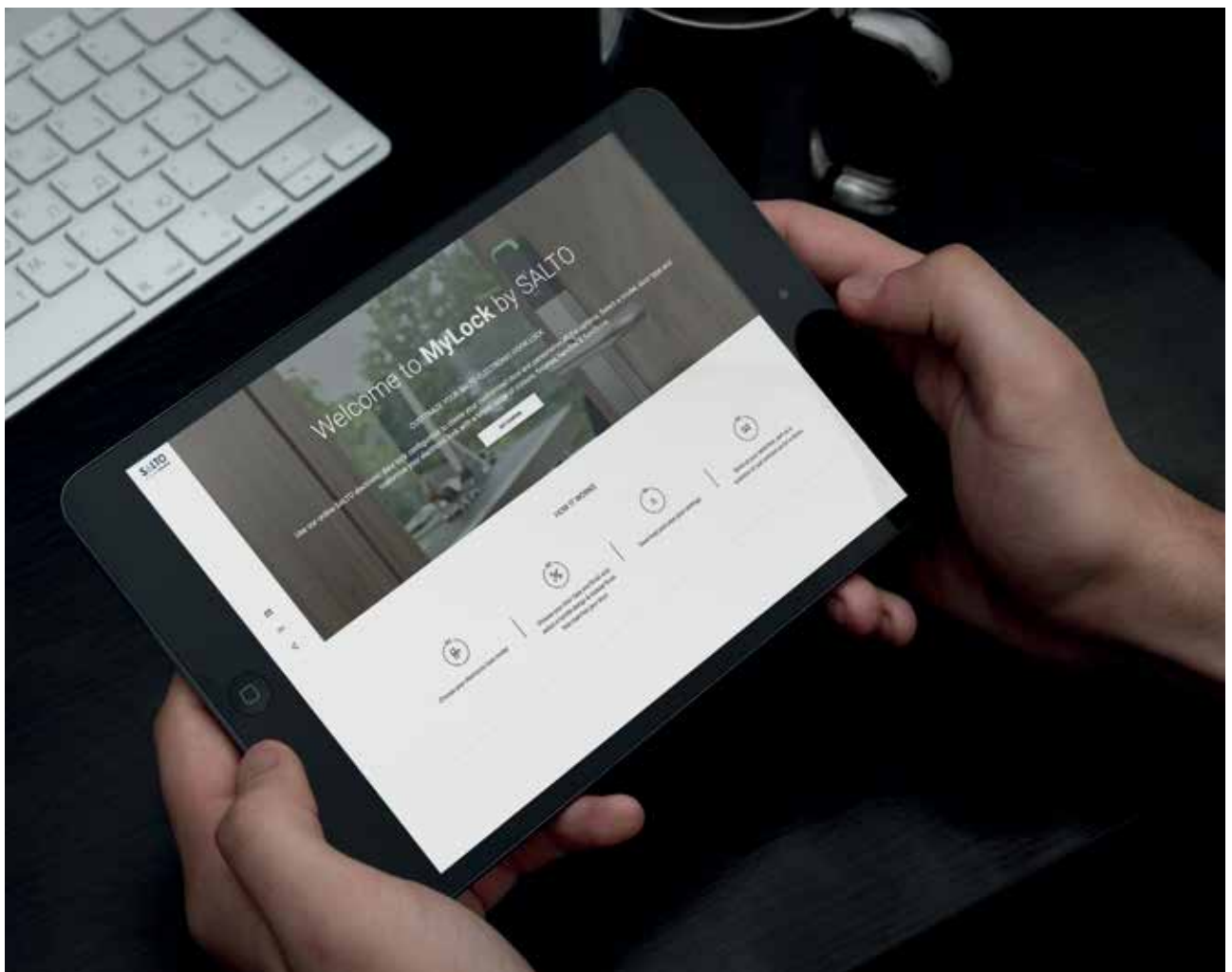



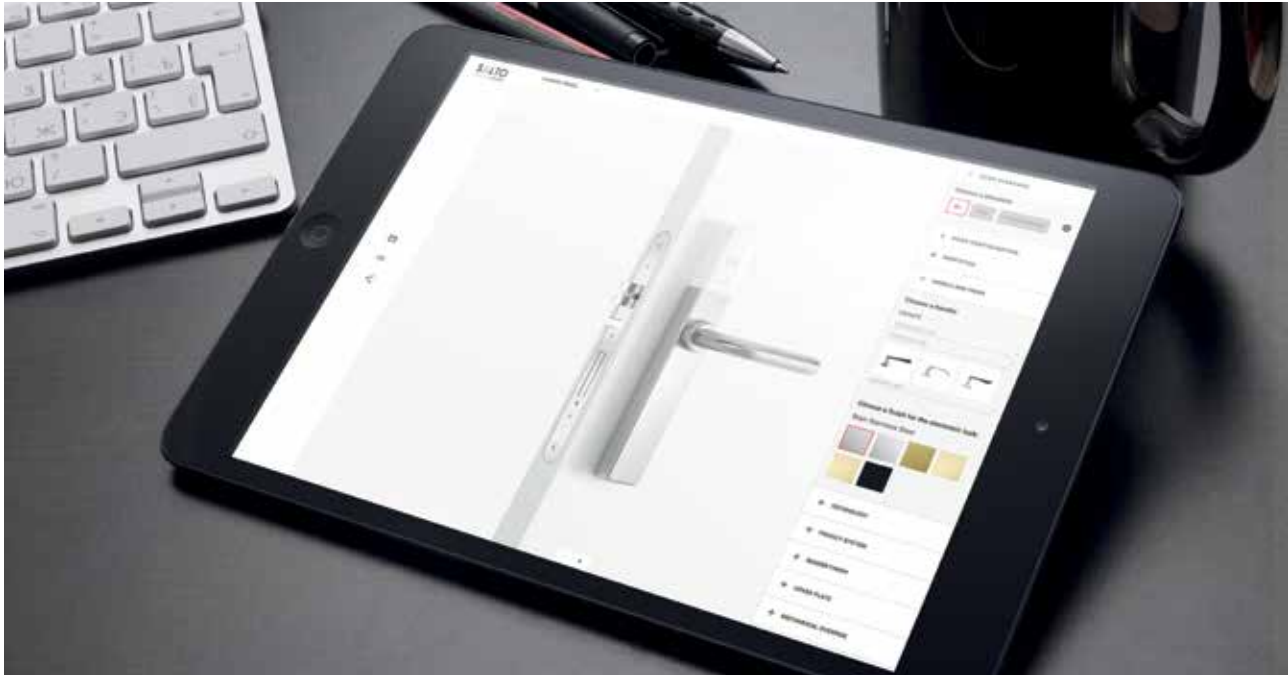



---

### CHOOSE YOUR ELECTRONIC LOCK MODEL:

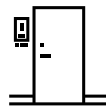
Choose your favorite electronic lock model (ANSI, Euro or Scandinavian standards), to create your customized door and personalise everything.



---

### CHOOSE YOUR DOOR TYPE AND SELECT A HANDLE DESIGN:

Choose your door type and finish and select a handle design & lockset finish that matches your door.



---

### DOWNLOAD AND SAVE YOUR SETTINGS:

Save your SALTO door lock. Once your door configuration is complete you can store and compare it against your previously configured door locks models or save it as a PDF format.





















---

### CONTACT US:

Send us your selection, ask us a question or just contact us for a demo.

# SALTO DOOR HANDLE FINISHES

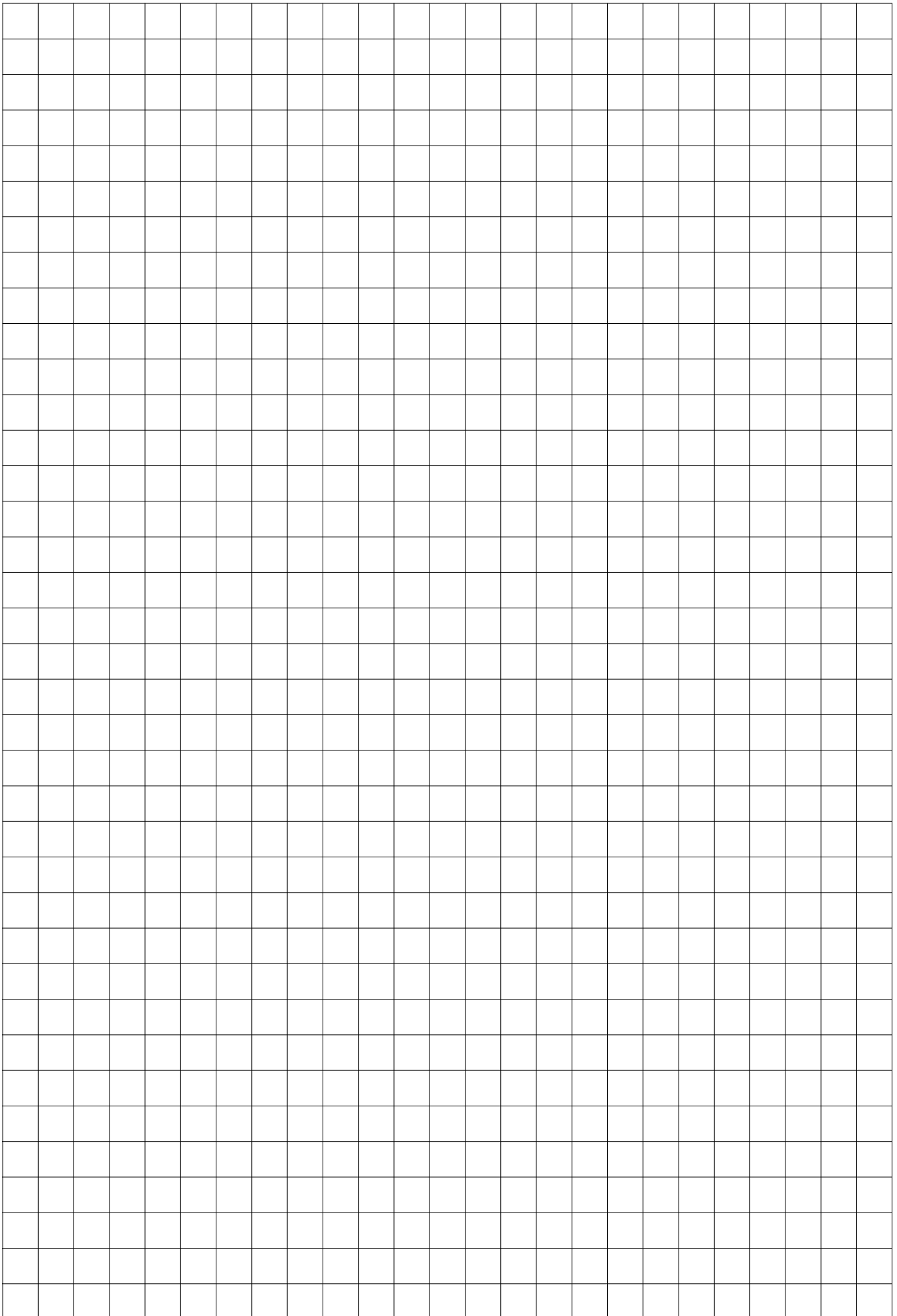
		Satin Stainless Steel (BHMA630 - US32D)	Bright Stainless Steel (BHMA629 - US32)	Antique Brass (BHMA638 - USS)	PVD Satin Brass (US4)	PVD Bright Brass (US3)	Black chromium NE
		IM	IP	IA	PM	PP	NE
<b>STANDARD LINE</b>							
L London		•	•	•	•	•	•
U Utrecht		•	•	•	•	•	•
W Washington		•	•	•	•	•	•
N New York		•	—	—	•	—	•
S Stocholm		•	—	—	—	—	•
Z Zodiac		•	—	—	—	—	•
<b>PREMIUM LINE</b>							
K Kingston		•	•	—	—	•	—
J Jakarta		•	—	•	•	—	•
O Ottawa		•	•	•	•	•	•
G Georgia		•	•	—	•	—	•
T Toronto		•	—	—	•	—	•
<b>LUXURY LINE</b>							
2 Robodue		•	•	—	—	•	—
3 Robotre		•	•	—	—	•	—
4 Roboquattro		•	•	—	—	•	—
5 Elle		•	•	—	—	•	—
7 Mach		•	•	—	—	•	—



The access control company you can rely on.

[www.saltosystems.com](http://www.saltosystems.com)

**SALTO**  
inspired access

**SALTO Systems HQ, Spain**

Oiartzun, Spain

Tel.: +34 943 344 550  
email: [info@saltosystems.com](mailto:info@saltosystems.com)  
[www.saltosystems.com](http://www.saltosystems.com)

**SALTO Systems, UK**

Southam, United Kingdom

Tel.: +44 01926 811979  
email: [info.uk@saltosystems.com](mailto:info.uk@saltosystems.com)  
[www.saltosystems.co.uk](http://www.saltosystems.co.uk)

**SALTO Systems, USA**

Norcross GA / New York NY, USA

Tel.: +1 770 452 6091  
email: [info.us@saltosystems.com](mailto:info.us@saltosystems.com)  
[www.salto.us](http://www.salto.us)

**SALTO Systems, Canada**

Vaudreuil-Dorion QC, Canada

Tel.: +1 514 616 2586  
email: [info.ca@saltosystems.com](mailto:info.ca@saltosystems.com)  
[www.saltosystems.ca](http://www.saltosystems.ca)

**SALTO Systems, Mexico**

Cancún, México

Tel.: +52 (998) 892 8752  
email: [info.mx@saltosystems.com](mailto:info.mx@saltosystems.com)  
[www.saltosystems.co.mx](http://www.saltosystems.co.mx)

**SALTO Systems, Colombia**

Bogota, Colombia

Tel.: +57 320 924 3634  
email: [info.co@saltosystems.com](mailto:info.co@saltosystems.com)  
[www.saltosystems.com](http://www.saltosystems.com)

**SALTO Systems, Australia**

Waterloo / Sydney, Australia

Tel.: +61 (0)2 9319 3393  
email: [info.au@saltosystems.com](mailto:info.au@saltosystems.com)  
[www.saltosystems.com.au](http://www.saltosystems.com.au)

**SALTO Systems, Middle East**

Dubai, United Arab Emirates

Tel.: +971 4399 5770  
email: [info.me@saltosystems.com](mailto:info.me@saltosystems.com)  
[www.saltosystems.com](http://www.saltosystems.com)

**SALTO Systems, France**

Nanterre, France

Tel.: +33 (0)1 55 17 13 70  
email: [info.fr@saltosystems.com](mailto:info.fr@saltosystems.com)  
[www.saltosystems.fr](http://www.saltosystems.fr)

**SALTO Systems, Germany**

Wuppertal, Deutschland

Tel.: +49 (0)202/ 769 579-0  
email: [info.de@saltosystems.com](mailto:info.de@saltosystems.com)  
[www.saltosystems.de](http://www.saltosystems.de)

**SALTO Systems, Switzerland**

Eschlikon, Switzerland

Tel.: +41 71 973 72 72  
email: [info.ch@saltosystems.com](mailto:info.ch@saltosystems.com)  
[www.saltosystems.ch](http://www.saltosystems.ch)

**SALTO Systems, Netherlands**

Amsterdam, The Netherlands

Tel.: +31 206 353 100  
email: [info.nl@saltosystems.com](mailto:info.nl@saltosystems.com)  
[www.saltosystems.nl](http://www.saltosystems.nl)

**SALTO Systems, Belgium**

Brussels, Belgium

Tel.: +32 25 88 50 68  
email: [info.be@saltosystems.com](mailto:info.be@saltosystems.com)  
[www.saltosystems.be](http://www.saltosystems.be)

**SALTO Systems, Poland**

Warszawa, Polska

Tel.: +48 609 01 7777  
email: [info.pl@saltosystems.com](mailto:info.pl@saltosystems.com)  
[www.saltosystems.pl](http://www.saltosystems.pl)

**SALTO Systems, Slovakia**

Bratislava, Slovakia

Tel.: +421 915 579 500  
email: [info.sk@saltosystems.com](mailto:info.sk@saltosystems.com)  
[www.saltosystems.com](http://www.saltosystems.com)

**SALTO Systems, Czech Republic**

Prague, Czech Republic

Tel.: +420 734 258 882  
email: [info.cz@saltosystems.com](mailto:info.cz@saltosystems.com)  
[www.saltosystems.com](http://www.saltosystems.com)

**SALTO Systems, Denmark**

Kalundborg, Denmark

Tel.: +45 48 44 88 11  
email: [info.dk@saltosystems.com](mailto:info.dk@saltosystems.com)  
[www.saltosystems.dk](http://www.saltosystems.dk)

**SALTO Systems, Norway**

Jessheim, Norway

Tel.: +47 63 95 40 20  
email: [info.no@saltosystems.com](mailto:info.no@saltosystems.com)  
[www.saltosystems.no](http://www.saltosystems.no)

**SALTO Systems, Sweden**

Stockholm / Malmö, Sweden

Tel.: +46 8-775 87 00  
email: [info.se@saltosystems.com](mailto:info.se@saltosystems.com)  
[www.saltosystems.se](http://www.saltosystems.se)

**SALTO Systems, Finland**

Vantaa, Finland

Tel.: +45 48 44 88 11  
email: [info.fi@saltosystems.com](mailto:info.fi@saltosystems.com)  
[www.saltosystems.fi](http://www.saltosystems.fi)

**SALTO Systems, Italy**

Bologna, Italy

Tel.: +39 051 72 77 98  
email: [info.it@saltosystems.com](mailto:info.it@saltosystems.com)  
[www.saltosystems.it](http://www.saltosystems.it)

**SALTO Systems, Portugal**

Lisboa / Porto, Portugal

Tel.: +351 220 937 508  
email: [info.pt@saltosystems.com](mailto:info.pt@saltosystems.com)  
[www.saltosystems.com](http://www.saltosystems.com)

**SALTO Systems, Singapore**

Singapore

Tel.: +65 6557 22 55  
email: [info.sg@saltosystems.com](mailto:info.sg@saltosystems.com)  
[www.saltosystems.com](http://www.saltosystems.com)

**SALTO Systems, China**

Shanghai, China

Tel.: +86 (21) 3157 6115  
email: [info.cn@saltosystems.com](mailto:info.cn@saltosystems.com)  
[www.saltosystems.com](http://www.saltosystems.com)

**SALTO Systems, Hong Kong**

Hong Kong

Tel.: +852 3169 1820  
email: [info.hk@saltosystems.com](mailto:info.hk@saltosystems.com)  
[www.saltosystems.com](http://www.saltosystems.com)

**SALTO Systems, South Africa**

Johannesburgo, South Africa

Tel.: +27 (83) 293 07 96  
email: [info.za@saltosystems.com](mailto:info.za@saltosystems.com)  
[www.saltosystems.com](http://www.saltosystems.com)